

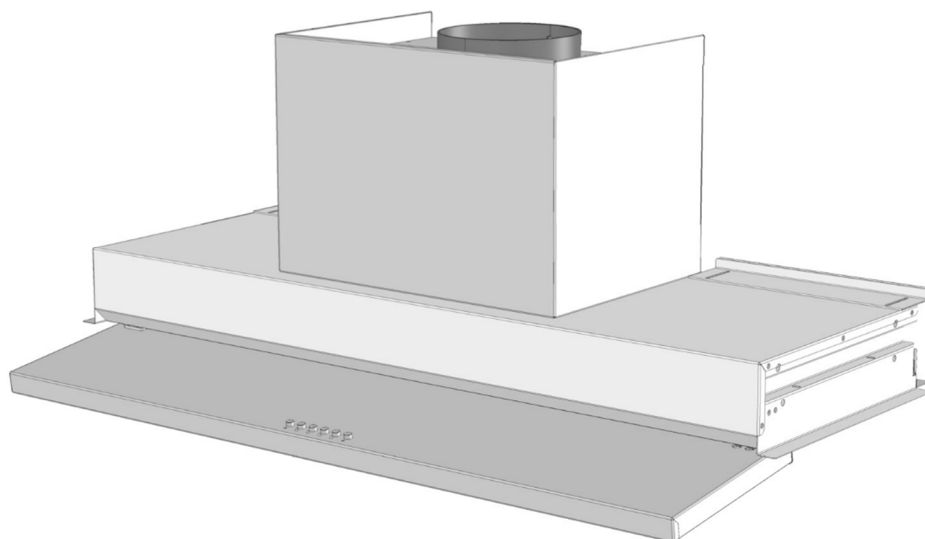

ALTO



INSTALLATION, OPERATING AND MAINTENANCE GUIDE



**Congratulations on purchasing your new
Miro Alto cooker hood.**

Register your warranty now:

www.miroproducts.co.uk/register-warranty/



220-240V 50Hz

220V 60Hz

GENERAL

Exhausting cooker hood. The equipment is constructed under European Standards and with the requirements included in the following Directives: 2014/35/UE (Low Voltage Directive), 2014/30/UE (Electromagnetic Compatibility).

The present instruction manual is an integral part of the appliance itself, therefore it must be carefully kept and ALWAYS accompany it, even in case of its assignment to another owner or user or in case the cooker hood is moved to another installation plant.

The Manufacturer strives for continuous improvements. For this reason, the text and illustrations in this guide may change without notice.

WARNING

Ensure the voltage (V) and frequency (Hz) on the data plate inside the appliance match the ones available in the place where it is installed.

Any modification that might be required in the electrical system in order to install the hood, must be carried out only by competent people. Repairs performed by untrained people can cause damage. For any intervention, please contact a Technical Service Centre authorized to carry out the replacements with spare parts. Always check that all electrical parts (lights, extractor) are switched off when the unit is not used. During storms, position the main switch on "OFF".

The use of the hood cannot be different from the use of cooking fume extractors in domestic cookers. The Manufacturer accepts no liability for any damages caused to people, animals or property, due to incorrect installation and maintenance or misuse.

We remind you that the use of products using electricity implies compliance with some vital safety rules:

- This appliance is not to be used by persons (children included) with reduced physical or mental capabilities or lacking experience and knowledge, unless supervised or instructed on its use by a person responsible for their safety. Children must be supervised to make sure they do not play with the appliance.
- Do not clean the appliance before disconnecting it from the power supply by turning the main switch to "OFF". If cleaning is not carried out in compliance with the instructions provided, a fire might develop.
- Do not pull, disconnect or twist the cables from the appliance, even if it is disconnected from the power supply.
- Do not spray or splash water on the appliance.
- Do not insert sharp objects through the air intake and delivery grilles.
- Do not remove the filters to access the internal walls of the appliance if you have not turned the main switch to "OFF".
- Do not flambé underneath the hood. When frying, keep the oil under constant control, since it can ignite.
- ATTENTION: when the hob is working, the accessible parts of the hood become hot.

This product can be installed at reduced distances from the hob compared to a normal kitchen hood. In this condition, the heating of all the surfaces of the hood, even those inside the cabinet, is completely normal and is not a sign of malfunction. Heating is accentuated if the hood is installed above a gas hob. It is therefore recommended not to store flammable material above the hood body inside the wall cabinet.

USE

This hood can be used in extracting or filtering mode.

Extracting (expulsion to the outside). Kitchen fumes are expelled through the piping (not supplied with the hood) connected to the motor discharge.

The piping must never be connected to combustion discharge pipes (stoves, boilers, burners, etc.).

The use of long pipes, with many bends, corrugated and with a diameter smaller than the motor outlet's will cause a decrease in extracting performance and an increase in noise.

Filtering (recycling). Kitchen fumes pass through the Long-Life anti-odor filter (not supplied with the hood and available as an accessory) to be purified and recycled in the kitchen. The use of the anti-odor filter reduces the hood performance.

INSTALLATION

Read the whole instruction booklet before installing and/or using the hood.

With the hood correctly installed, the minimum distance between the wall-mounted unit and the cooking surface of a gas stove must be at least 65 cm.

With the hood correctly installed, the minimum distance between the wall-mounted unit and the cooking surface of an induction cooker must be at least 50 cm.

Please comply with all the regulations regarding air discharge. The air must never be discharged into a duct used to discharge the fumes produced by gas combustion appliances (not applicable to hoods used in filtering mode).

The room must have sufficient ventilation when the hood is used together with other appliances that use gas or other fuel. During installation, we recommend you move the units underneath it for better accessibility.

The hood is supplied with all the fixings required to install it, suitable for most wall units. Check anyway that the surface of the wall units is adequate.

Installation must be carried out by competent and qualified installers in compliance with the regulations in force.

- The hood is provided with a plastic back spacer to adapt its depth to that of the wall unit (from 30 to 35 cm). Proceed measuring the depth of the wall unit side "X" (Fig. 1), deduct from this value the depth of the hood that is 30cm. The difference is depth "A" (Fig. 1), the distance the spacer will have to be cut at with a cutter. If the wall unit depth is 30 cm, no spacer is required.
- At this point, fix the already cut spacer to the hood (Fig. 2).
- Fix the two brackets supplied to the unit internal walls, complying with the distances shown (Fig. 3).

- Insert the hood from the front; use the previously fixed brackets as guides that must be inside the seat located on the hood sides (Fig. 4).
- After positioning the hood correctly, fix it to the guides with the 4 screws supplied (Fig. 5).
- Now insert the two horizontal backstops, having first unloaded the backrest at the height indicated in Fig. 6.
- Then position the two vertical covers and fasten everything with the relative screws (Fig. 7).

ELECTRICAL CONNECTION

This appliance must be connected to an earthed system.

Two types of connection to the network are possible:

1. With a standard plug connected to the mains cable and inserted in an accessible system socket (that can be disconnected during maintenance). Ensure the plug is accessible also once the installation is completed.
2. With a fixed connection to the mains, placing in-between a bipolar switch ensuring disconnection from the mains, with a distance in the contact opening that allows complete disconnection from the mains in the conditions of overvoltage category III, in compliance with the installation regulations. The earth connection (yellow-green wire) must not be interrupted. For voltages and frequency, check the data plate inside the appliance.

If the power cable is damaged, it must be replaced by the manufacturer or by its technical service centre or, anyway, by a qualified person, in order to prevent any risk.

OPERATION

This hood has been designed to prevent the formation of condensation on its lower surfaces when it is installed over an induction cooker.

Unlike a gas stove, an induction cooker heats only the pans containing the food and not the surrounding area, so the surfaces of the hood remain cold.

When the hot cooking fumes go up, they hit the hood cold surfaces, condense and therefore release the humidity in the air that quickly transforms into small water drops that inevitably fall on the cooking surface and food, carrying with them fat and impurities.

To prevent this from happening, all the lower surfaces of the hood are heated by a system of internal and therefore invisible resistors, so the hood lower surfaces getting warm, even without switching the cooker on, is quite normal and does not show that the product is not working properly. To switch the hood on, first open the fume flap using the relative handle in the lower part. Lightly pull downwards and then extract flap "A" fully (Fig. 8).

To correctly close the flap you will have to act in the center of the same pushing it towards the wall and then upwards. If you push on one side to close the flap, it may not close properly. A special sensor will automatically switch the hood off when you try and close the flap with the hood on.

The controls consist of keys to switch the TL light on, to switch speed one on and switch extractor T1 off, to select the T2-T3-T4 running speeds (Fig.9). Pressing the T4 button selects the intensive speed (maximum suction), the aspirator remains at this speed for 5 minutes (with the button flashing) and then it will automatically switch to the third speed. To activate the anti-condensation function, press the T5 button (Fig.9). The anti-condensation function comes automatically on when the hood is switched on with key T1, it can anyway be switched on and off with key T5. The anti-condensation function is active when the key T5 is illuminated in red.

To switch the motor off, press T1 only once if the hood is operating in 1st speed, twice if it is running at other speeds.

Light adjustment, with the blower turned off:

TL single click: on/off at the stored brightness and temperature.

TL long press (for more than 1 second) when on: brightness adjustment:

- Start from stored setting, DOWN ---> UP adjustment, if not released, the maximum brightness is set
- With another long press, the UP ---> DOWN adjustment goes to minimum brightness
- When the button is released, both at maximum/minimum and during adjustment, the desired intensity is stored for the next switch-on

TL+T4 when on: colour temperature adjustment (same steps as brightness adjustment)

The internal fat filter is not heated to allow condensating most of the humidity in the air, therefore drops may form on this surface and will be collected in a special tray. As soon as you finish cooking, it is advisable to check the presence or absence of water in the tray. The possible absence of water in the tray is not a sign of the incorrect operation of the product. To empty the container, first of all open fume flap "A" (Fig. 8), with the hood switched off, pull lever "B" (Fig. 10), located in the back of condensate tray "C" downwards (Fig. 10) and at the same time position a container under drain valve "D" (Fig. 10) present in the lower part of the same tray. The collected water and impurities will drain from this valve.

The hood should be switched on a few minutes before starting cooking to allow the lower parts to warm up and left on until all odors have disappeared.

While cooking, keep the hood maximum extracting speed on to get the best possible performance in terms of both extraction and reduction in surface condensation.

For high-release steam cooking, it is recommended to use the rear hotplates of the induction hob.

Activation of adjustable delayed auto-off function

With the hood in operation, select the desired speed, press without releasing the key of the speed corresponding to the auto-off minutes you wish to set, until it starts flashing, keeping in mind that: T1 equals 5 minutes; T2 equals 10 minutes;

T3 equals 15 minutes

The set speed can be modified during the auto-off time.

If the auto-off time chosen is the same as the set speed, the speed LED flashes; if a different time is chosen, the speed LED remains fixed. The hood must be switched off to disable the self-switch-off.

MAINTENANCE WARNING

Anti-grease filter

Every 30 hours of hood operation, when the hood is switched off, all the LEDs of the speed buttons turn on with a fixed light for 30 sec. to warn the grease filter “E” needs to be cleaned (Fig. 11). To reset the timer, simply hold down the T1 key (Fig.9) with the blower Off, otherwise the device will give the alarm the next time the hood is switched off.

Long-Life odor filter (for filtering hoods)

Every 120 hours of hood operation, when the hood is switched off, all the LEDs of the speed buttons turn on with a flashing light for 30 sec. as a reminder of the regeneration of the Long- Life filter “F” (Fig.11) and the cleaning of the anti-grease filters “E” (Fig.11). To reset the timer, simply hold down the T1 key (Fig.9) with the blower Off, otherwise the device will give the alarm the next time the hood is switched off.

Full condensate container warning

An electronic internal sensor immediately switches the hood off and the speed LEDs on when the water in the condensate collection tray reaches the maximum level. To zero the warning and switch the hood back on, the condensate collection tray needs to be emptied.

MAINTENANCE

Before any maintenance or cleaning, disconnect the hood from the mains and check there are no pans on the cooking surface.

The hood must be cleaned immediately after installation and the removal of the protective film in contact with the steel in order to eliminate any glue residues and other potential impurities.

The hood must be cleaned regularly and carefully, both inside and out (at least once a month).

Do not allow dirt to accumulate on the external and internal surfaces of the hood.

Do not use acid or base products or abrasive sponges to clean the external frame.

Clean the hood with a sponge dampened with warm water and a small quantity of neutral detergent (e.g. washing-up liquid) to eliminate any traces of fat that may have deposited on it. Rinse with a damp cloth, removing all detergent carefully, following the direction of the satin finish of the steel surface. Drying, above all in the areas where water is very hard and leaves scale deposits, is particularly important.

Pay careful attention to the fat filter, which is used to withhold the fat particles contained in the steam. The fat filter must be washed when the relative warning is displayed or at least once a month in warm water and detergent (in the dishwasher too). After a few washes the filter may discolour. This is normal and does not mean that it must be replaced.

For any maintenance, the fat filter must be removed from the hood. First of all, open the fume flap of the hood using the appropriate handle located in the lower part, to do this slightly pull downwards and then extract flap “A” fully (Fig. 8).

With the hood switched off, open the condensate tray “G” (Fig. 13) pulling from the back “I” (Fig. 14). The tray will lower slightly and rotate on itself at the front “L” (Fig. 14) to finally come down.

You will then access the internal fat filter and be able to take it out with the relative handle “H” (Fig. 13).

At this point you can proceed and clean the filter.

To reinstall the fat filter, repeat the instructions in reverse order.

The Long-Life anti-odor filter, where present, captures all the odors present in the cooking fumes, guaranteeing pure air in your kitchen.

It does not need to be replaced frequently as a normal activated carbon filter, it can in fact be regenerated every 3-4 months, and in any case according to the frequency of use of the hood, with a usual washing in the dishwasher at about 70°C without any type of detergent, followed by drying in the oven for 30 minutes at 70°C. To keep its efficiency high, it is recommended to replace the Long-Life filter after 6/8 regeneration cycles.

After 6/8 regeneration cycles, the Long-Life odor filter and the frame that encloses it must be replaced.

To remove the anti-odor filter, first of all open the fume flap of the hood using the appropriate handle located in the lower part, to do this slightly pull downwards and then extract flap “A” fully (Fig. 8). With the hood switched off, open the condensate tray pulling it from the back “I” (Fig. 14). The tray will lower slightly and rotate on itself at the front “L” (Fig. 14) to finally come down.

You will then access the internal fat filter and be able to take it out with the relative handle “H” (Fig. 13).

The anti-odor filter is located above the fat filter. To remove the anti-odor filter, slide the steel frame containing it towards the back (Fig. 12). Once the frame has been extracted, the anti-odor filter inside it can be removed and washed, regenerating it. To reinstall the anti-odor filter, reverse the operations.

The hood is fitted with a LED lamp that, apart from guaranteeing good lighting and considerable power savings, ensures an average life 10 times longer than traditional lamps.

DISCONTINUATION

The discontinuation means the definitive shutdown and disassembly of the appliance.

After discontinuation, the appliance can be installed on another piece of furniture, privately resold, or disposed of.

Caution! For discontinuation, it is necessary to switch the appliance off and disconnect the power.

Disassembly requires that the device is accessible and has been disconnected from the power supply.

To do this, follow the installation instructions in reverse order.



This appliance is marked under the European Directive 2012/19/EC, Waste Electrical and Electronic Equipment (WEEE).

The symbol on the product or the packaging indicates that the product should not be considered as normal household waste, but must be taken to the appropriate collection point for the recycling of electrical and electronic equipment.

The appropriate disposal of this product helps to avoid potential negative consequences for the environment and health. For more detailed information, contact your local office, local waste disposal service, or the shop where you purchased the product.

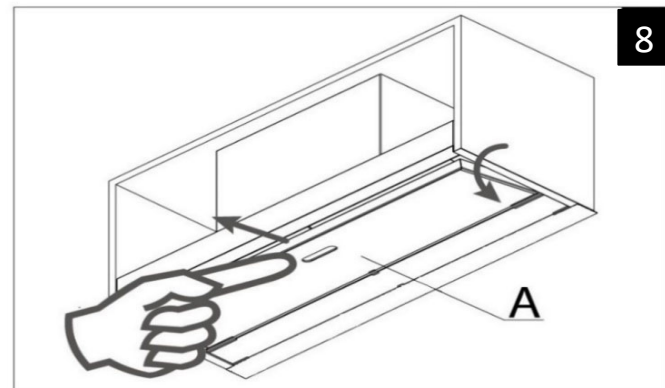
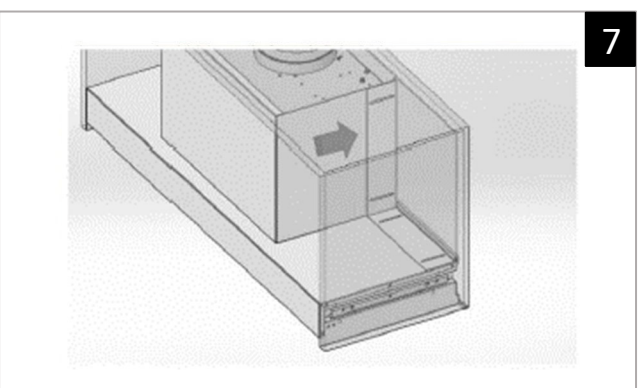
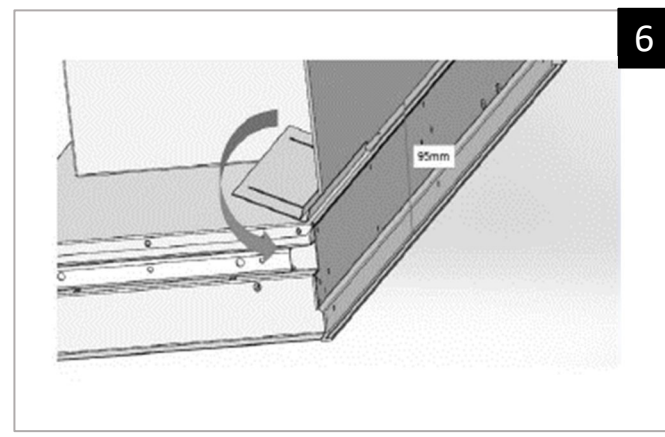
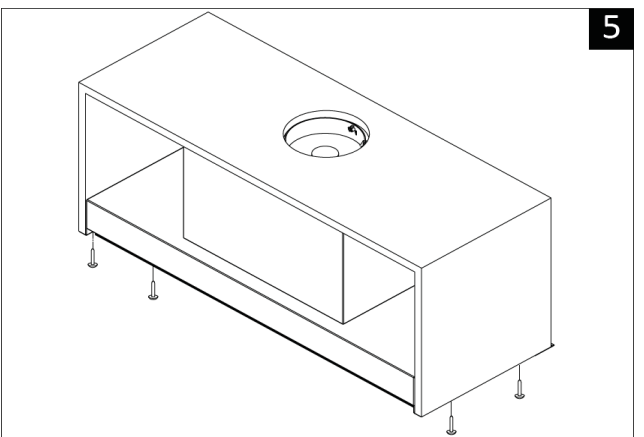
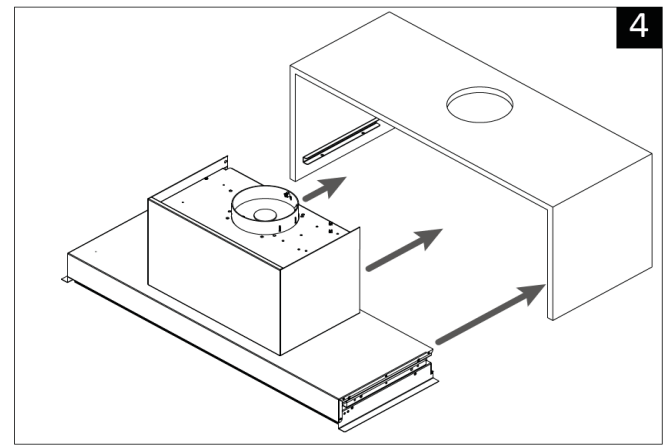
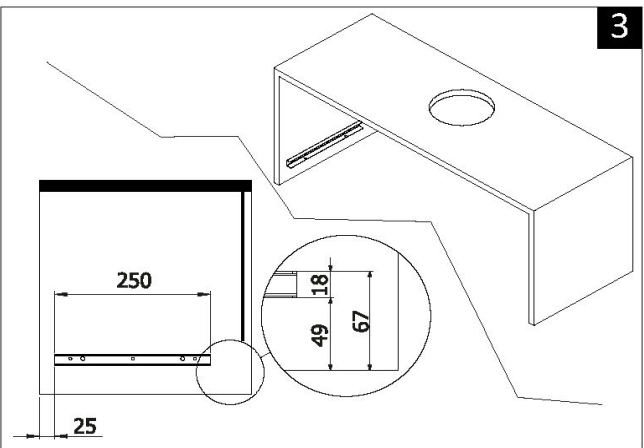
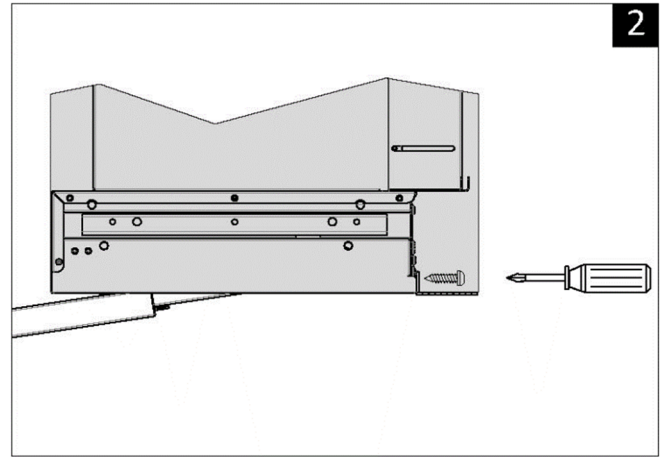
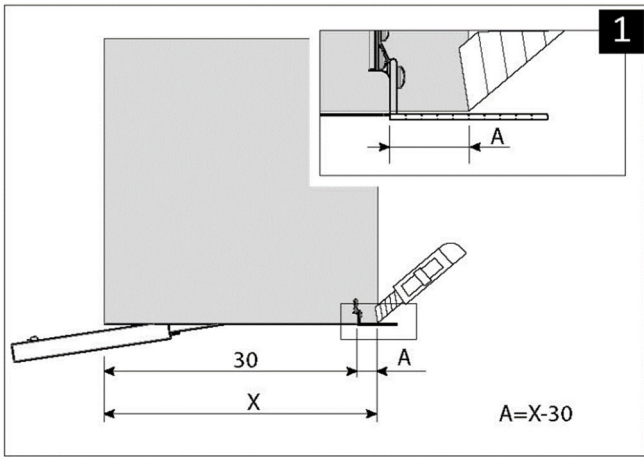

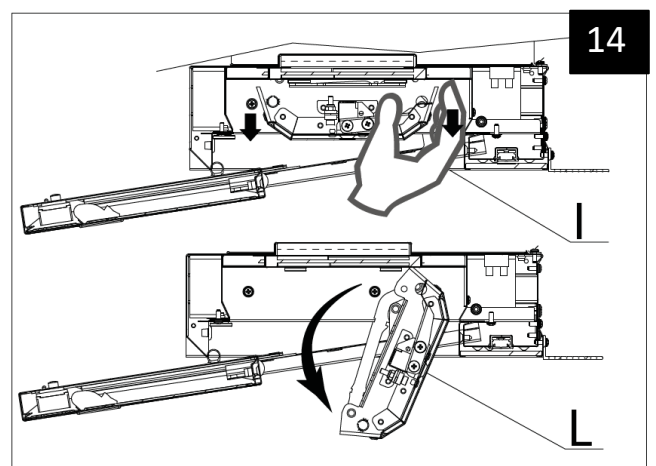
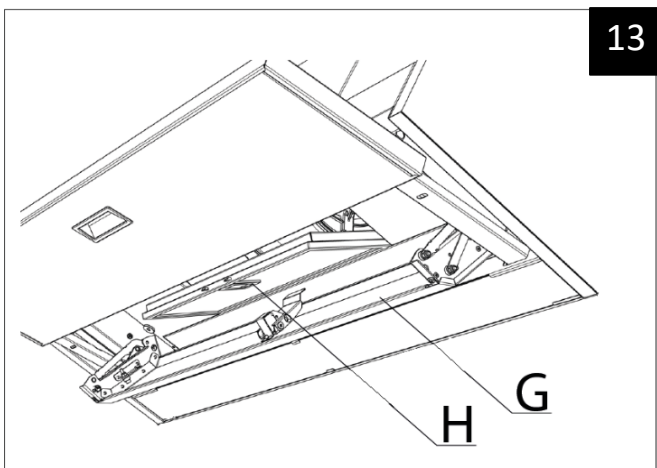
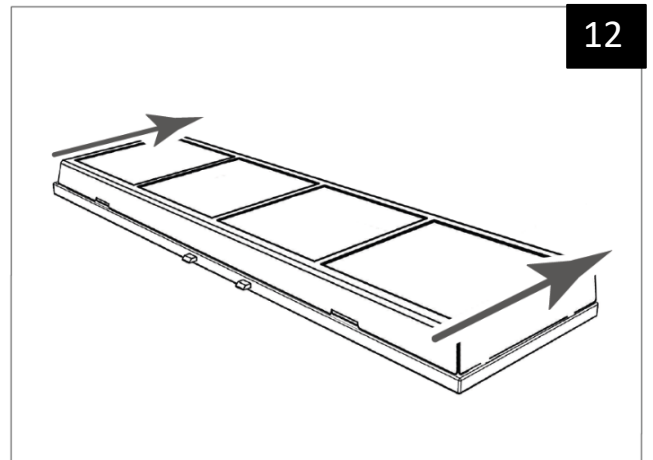
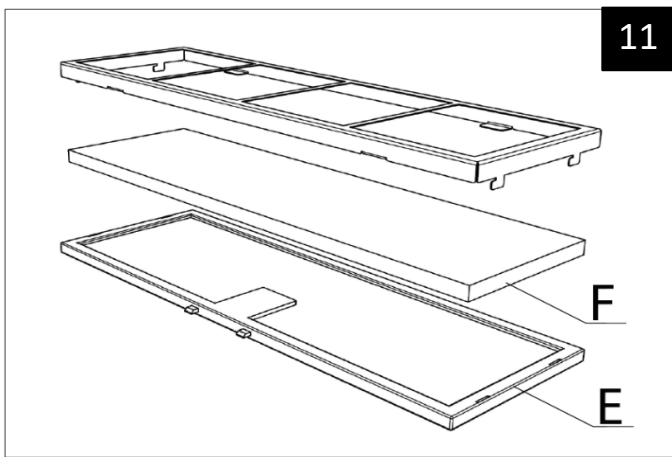
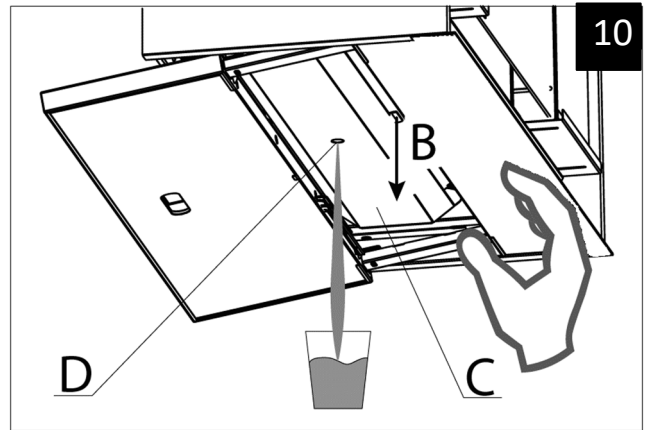
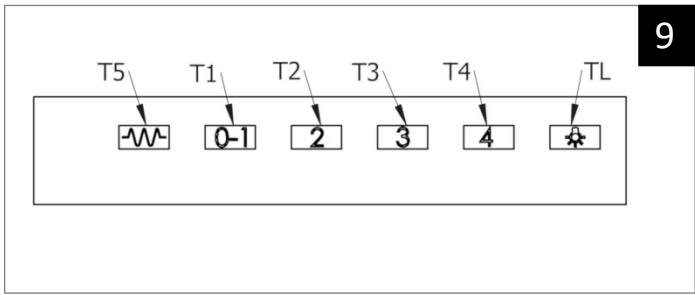



Miro Products Limited
Unit 9, Evolve @ Vision Park
Whittle Way, Burnley
Lancashire, BB12 0AW
www.miroproducts.co.uk
01282 450238