

**FISHER & PAYKEL**

**INTEGRATED INSERT COOKER HOOD**



**INTEGRATED**

HP60IHCB4, HP90IHCB4 models

**USER GUIDE**

**UK IE EU**



## CONTENTS

---

Safety and warnings	4
Cooking considerations	7
First use	8
Wi-Fi connection	9
Light settings	10
Care and cleaning	11
Parts and accessories	13
Troubleshooting	14
Manufacturer's Warranty	15
Customer care	16
European Directive 2012/19/EU on Waste Electrical and Electronic Equipment (WEEE)	18

---

### Registration

To register your product visit our website: [fisherpaykel.com/register](http://fisherpaykel.com/register)

**⚠ WARNING!**

**Electric Shock Hazard**

Failure to follow this advice may result in electrical shock or death.



- Always disconnect the appliance from the mains power supply before carrying out any maintenance or repairs. Failure to do so can result in death, electric shock, fire or injury to persons.
- Do not immerse cord or plugs in water or other liquid.

**⚠ WARNING!**

**Weight Hazard**

Failure to follow this advice may result in personal injury.



- The appliance is heavy. Please ensure adequate care is taken when installing the appliance to prevent personal injury. The appliance must be installed onto a solid wall, stud, beam or truss.
- **Product weight:** cooker hood from 6.4kg - 26kg. Refer to your installation guide for exact model weights.

**⚠ WARNING!**

**Cut Hazard**

Failure to use caution could result in injury.



- Take care: some edges are sharp.
- Wear gloves to protect against sharp edges.

## SAFETY AND WARNINGS

---

### READ AND SAVE THIS GUIDE

#### **WARNING!**

When using this appliance always exercise basic safety precautions including the following:

##### **General**

- This appliance is not intended for use by persons (including children) with reduced physical, sensory or mental capabilities, or lack of experience and knowledge, unless they have been given supervision or instruction concerning the use of the appliance by a person responsible for their safety.
- Children should be supervised to ensure they do not play with the appliance.
- Cleaning and user maintenance shall not be made by children without supervision.
- Do not flambé under the cooker hood.
- CAUTION: accessible parts may become hot when used with cooking appliances.
- Remove all packaging, including protective wrappings, before use.
- The room must have adequate ventilation when the cooker hood is used at the same time as appliances burning gas or other fuels.
- The cooker hood may stop working during an electrostatic discharge (eg lightning). Switch off the electricity supply to the cooker hood and reconnect after one minute.
- Never leave frying food unattended since grease can overheat and catch fire. The risk of fire is even greater in the case of used oil.

##### **Installation**

- Please read the entire set of instructions before installing or using this appliance.
- Please make this information available to the person installing the appliance – doing so could reduce your installation costs.
- Always switch the power off prior to installation, servicing or cleaning of the appliance.
- This appliance must be installed and connected to the mains power supply only by a suitably qualified person according to these installation instructions and in compliance with any applicable local building and electricity regulations. Failure to install the appliance correctly could invalidate any warranty or liability claims.
- To comply with electrical safety regulations, the appliance must be plugged into a socket near the appliance. The socket must be accessible, or have an accessible isolating switch, to enable the end user to isolate the appliance from the power for the purpose of internal cleaning or maintenance.
- A power outlet should be within 750 mm of the cooker hood and can either be on the wall or in the ceiling.
- If the supply cord of this equipment is damaged, it must only be replaced by the manufacturer, its service agent or similarly qualified person in order to avoid a hazard.
- All ducting must comply with local requirements and building codes.
- Attention should be given to ensure that any applicable regulations concerning the discharge of exhaust air are fulfilled.
- To reduce risk of fire and to properly exhaust air, be sure to duct air outside—do not vent exhaust air into spaces within walls or ceilings or into attics, crawl spaces, or garages.
- Before connecting any pipes, consult municipal ordinances to ensure that any applicable regulations concerning the discharge of exhaust air are adhered to and request permission from the person in charge of the building.
- To reduce the risk of damage occurring to the cooktop, it is recommended that the surface of the cooktop is protected with cardboard or a similar object during installation of the cooker hood.

## SAFETY AND WARNINGS

---

- When cutting or drilling into wall or ceiling, do not damage electrical wiring and other hidden utilities.
- **WARNING:** Failure to install the screws or fixing device in accordance with these instructions may result in electrical hazards.
- Exhaust air must not be discharged into an existing flue that is used for exhausting fumes from appliances burning gas or other fuels.
- When the cooker hood and appliances supplied with energy other than electricity are simultaneously in operation, the negative pressure in the room must not exceed 4 Pa ( $4 \times 10^{-5}$  bar).
- **CAUTION:** In order to avoid a hazard due to inadvertent resetting of the thermal cut-out, this appliance must not be supplied through an external switching device, such as a timer, or connected to a circuit that is regularly switched on and off by the utility.
- The minimum distance between the supporting surface for cooking vessels on the hob and the lowest part of the cooker hood shall be 600mm, or 650mm if installed over a gas hob. If the instructions for installation for a gas hob specify a greater distance, this has to be taken into account.
  - The distance of 65cm can be reduced for:
    - non-combustible parts of cooker hoods, except grease filters, and/or
    - parts operating at safety extra low voltage, provided these parts do not give access to live parts if deformed.

### Maintenance

- Unplug or disconnect the appliance from the power supply before servicing or cleaning.
- You must read the details concerning the method and frequency of cleaning.
- There is a risk of fire if cleaning is not carried out in accordance with the instructions in your user guide.

# COOKING CONSIDERATIONS

---

## Induction

Induction cooktops use energy-efficient technology that only heats the contents of a cooking pot, not the surrounding air. As a result, there is more likelihood of condensation on cooker hood filters, splashbacks and surrounding cabinetry than when you use traditional electric or gas cooktops.

Other factors that influence condensation are room temperature, humidity, natural ventilation of the room, size of the cookware and how the induction cooktop is being used. For example, rapid boiling increases the likelihood of condensation. It is important to understand that neither the cooker hood nor the induction cooktop are faulty.

## Reducing condensation

- When boiling, use the cooker hood on a lower speed setting and the induction cooktop on a lower heat setting.
- Switch the cooker hood on 5 minutes before cooking and let it run for at least 5 minutes after cooking.

## Gas

Cooker hood surfaces may become hot if using a powerful gas cooktop or multiple gas burners operating at the same time. This effect can be reduced by using the maximum speed setting to enable hot air to be extracted quickly.

## Optimising performance

- Turn your cooker hood on for a few minutes before cooking. This will establish air currents up through the cooker hood, remove hot air from your kitchen and keep the cooker hood surface cool.
- Reduce fan speed for normal use and increase it for high heat, strong odours or fumes.

# FIRST USE

## Control panel



① <b>Power</b>	Press to turn the rangehood on/off. The fan automatically turns on at lowest fan speed and lights turn on to the last used level. Fan will turn off after 4 hours with no interaction.
② <b>Timer</b>	Press to turn the timer on. The fan operates for 5 minutes at the current speed and 2 minutes at each descending speed before turning off.
③ <b>Lights</b>	Press to turn lights on/off or change settings. Refer to 'Light settings'.
④ <b>Reduce fan speed</b>	Press to reduce fan speed.
⑤ <b>Fan speed indicator</b>	Illuminates to indicate fan speed.
⑥ <b>Increase fan speed</b>	Press to increase fan speed.
⑦ <b>Boost</b>	Press to turn the fan onto boost speed. Reverts to speed 4 after 5 minutes.
⑧ <b>Wi-Fi</b>	Press to start Wi-Fi connection process.
⑨ <b>Link mode</b>	Press to start linking to a compatible cooktop, then follow instructions on the cooktop to connect. Rangehood will turn on/off automatically while cooking.
⑩ <b>Filter cleaning mode</b>	Illuminates to indicate filters require cleaning. Press once to reset.



## WI-FI CONNECTION

---

Your appliance may be connected to your home wireless network and operated remotely using the app.

### Getting started

- Ensure your home Wi-Fi network is turned on.
- You will be given step-by-step guidance on your mobile device.
- It may take up to 10 minutes to connect your appliance.
- For further guidance and troubleshooting, please refer to the app.

### On your mobile device:

- ① Download the app from [www.fisherpaykel.com/connect](http://www.fisherpaykel.com/connect)
- ② Register and create an account.
- ③ Add your appliance and set up the Wi-Fi connection.

### Connecting to your home Wi-Fi

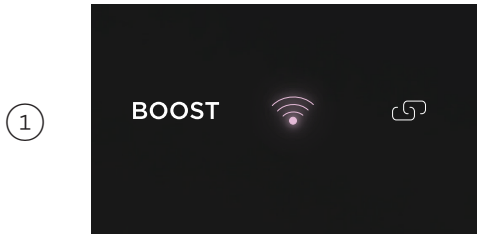

Press Wi-Fi button. It will start to flash.  
Follow the instructions in the app to complete the connection within 15 minutes.

### Disconnecting from your home Wi-Fi

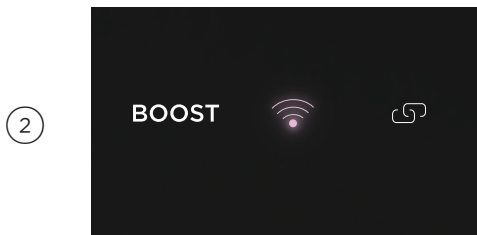

Press and hold Wi-Fi button for 5 seconds until it flashes, or open the app and remove rangehood.

Connection will time out after 15 minutes.

## LIGHT SETTINGS

---

Lights can be adjusted for brightness or colour temperature. They will turn off after 12 hours with no interaction.

### Adjusting brightness level

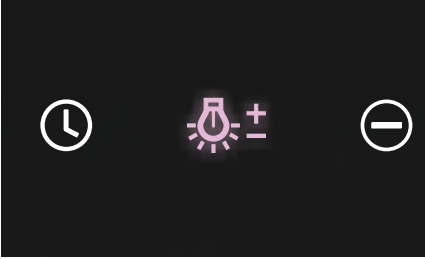

With rangehood ON, press and hold Lights button to adjust brightness level. You can also adjust brightness via the app.

### Changing colour temperature

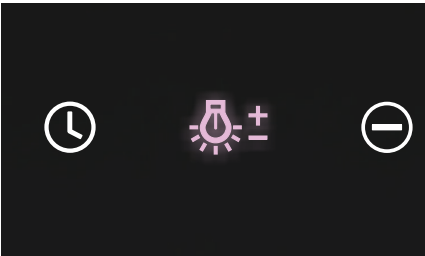

With rangehood OFF, press and hold Light button until adjacent buttons flash red for WARM or white for COLD.

Press again to switch between options. To confirm, press and hold until flashing stops. You can also change colour temperature via the app.

## CARE AND CLEANING

Disconnect the product from the power source before undertaking any cleaning. Clean your cooker hood regularly using a mild, liquid detergent and a clean soft cloth to avoid a build-up of grease. Avoid the use of corrosive chemicals, abrasive cleaning products, hard brushes and steel wool pads. In areas of high humidity or coastal environments, cleaning should be carried out more frequently.

Do not operate the hood without filters in place.

### Aluminium filters

- Clean the filters at least once a month. Filters may need to be cleaned more frequently depending on the cooking methods used and frequency of use.
- Aluminium filters should be removed and cleaned with hot soapy water or in a dishwasher.
- If washed in a dishwasher, the filter should be placed in an upright position to prevent food from falling on them.
- After rinsing and drying, refit the filters.

### Removing the aluminium filters



Open the perimeter plate.

Pull the catch and tilt the filter downwards until it disengages from the supports.

### Replacing the aluminium filters



Place the filter into the support at the rear of the cooker hood. Push the filter back into place.

Close the perimeter plate.

## CARE AND CLEANING

---

### Carbon filters (some models only)

Carbon filters are for use in recirculating mode. They are disposable and must be replaced at least every three months to ensure the performance of the cooker hood. In the event of a fire, grease-laden filters could be flammable.

### Removing the carbon filters

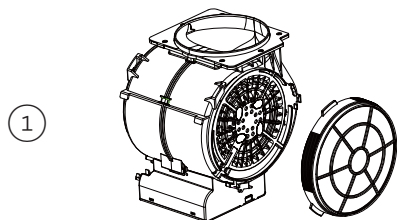

Remove the aluminium filters from the cooker hood before removing the carbon filters.

### Replacing the carbon filters

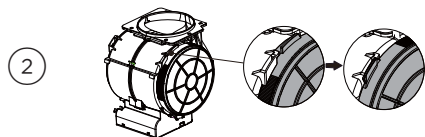

Place a new carbon filter on each side of the motor inlet and turn until they clip into place. Refit aluminium filters.

### Replacing LED lights

Please contact your Fisher & Paykel trained and supported service technician. Refer to [fisherpaykel.com](http://fisherpaykel.com) for contact details.

## PARTS AND ACCESSORIES

---

ITEM	REFERENCE NUMBER
Aluminium filter 60cm	792942
Aluminium filter 90cm	792943
Carbon filter x 2	793599

## TROUBLESHOOTING

If there is a problem with your cooker hood, please check the following points before contacting your local Fisher & Paykel trained and supported service technician or the Customer Care Centre.

PROBLEM	POSSIBLE CAUSE	WHAT TO DO
<b>Airflow is lower than expected</b>	The ducting is blocked.	Check the ducting and external vent for kinks or blockages.
	Incorrect ducting used.	Check that the correct ducting has been used as per the installation guide.
	Ducting route is very long.	Check the ducting route is as short as possible.
	Incorrect ducting used in installation.	Check ducting is installed as per the installation guide.
	Ducting installed incorrectly.	Check ducting is installed as per installation guide, with no loose sections, kinks or vibrations.
<b>Wi-Fi button is flashing white</b>	Cooker hood is trying to reconnect to the Wi-Fi network.	Check your Wi-Fi router.
	Cooker hood is still connected to old Wi-Fi network.	Press and hold Wi-Fi button until it flashes red. Open SmartHQ App and follow instructions on screen.
<b>App not working to control cooker hood</b>	You are not connected to the internet.	Check your Wi-Fi router.
<b>Link button flashing white</b>	Cooker hood is trying to reconnect to the cooktop.	Check your cooktop.
<b>Excessive condensation forms on the cooker hood</b>	Using an induction cooktop.	Condensation can be minimised. Refer to 'Cooking considerations'.
	High ambient temperature, humidity or low natural ventilation in the room.	
	Height of cooker hood installation.	

## MANUFACTURER'S WARRANTY

---

You automatically receive a 2-year manufacturer's warranty with the purchase of this product covering parts and labour for servicing within the country of purchase.

### **Fisher & Paykel undertakes to:**

Repair or, at its option, replace without cost to the owner either for material or labour any part of the product, the serial number of which appears on the product, which is found to be defective within TWO YEARS of the date of purchase.

Note: this Manufacturer's Warranty is an extra benefit and does not affect your legal rights.

### **This Manufacturer's Warranty DOES NOT cover**

- Ⓐ Service calls which are not related to any defect in the product. The cost of a service call will be charged if the problem is not found to be a product fault. For example:
  - ① Correcting the installation of the product.
  - ② Instructing you how to use the product.
  - ③ Replacing house fuses or correcting house wiring or plumbing.
  - ④ Correcting fault(s) caused by the user.
  - ⑤ Noise or vibration that is considered normal, eg drain/fan sounds, refrigeration noises or user warning beeps.
  - ⑥ Correcting damage caused by pests, eg rats, cockroaches, etc
  - ⑦ Replacement light bulbs.
- Ⓑ Defects caused by factors other than:
  - ① Normal domestic use; or
  - ② Use in accordance with the product's user guide.
- Ⓒ Defects to the product caused by accident, neglect, misuse or 'act of God'.
- Ⓓ The cost of repairs carried out by non-trained and supported service technicians or the cost of correcting such repairs.
- Ⓔ Normal recommended maintenance as set out in the product's user guide.
- Ⓕ Repairs when the appliance has been dismantled, repaired or serviced by other than a Fisher & Paykel trained and supported service technician or the selling dealer.
- Ⓖ Pick-up and delivery.
- Ⓗ Transportation or travelling costs involved in the repair when the product is installed outside the Fisher & Paykel trained and supported service technician's normal service area.

Nothing in this Manufacturer's Warranty is intended to, or does, limit any rights you may have under law to recover the costs of inspecting or returning the goods to us.

This product has been designed for use in a normal domestic (residential) environment. This product is not designed for commercial use (whatsoever). Any commercial use by a customer will affect this product's Manufacturer's Warranty.

Service under this Manufacturer's Warranty must be provided by a Fisher & Paykel trained and supported service technician (refer to the 'Customer Care' section at the back of this book). Such service shall be provided during normal business hours. This Manufacturer's Warranty certificate should be shown when making any claim.

**Please keep this user guide in a safe place.**

## CUSTOMER CARE

---

### **Before you call for service or assistance...**

Check the things you can do yourself. Refer to your user guide and check that:

- ① Your product is correctly installed.
- ② You are familiar with its normal operation.

If after checking these points you still need assistance or parts, please refer to your nearest Authorised Service Centre, Customer Care, or contact us through our local website listed on the back cover.

### **In United Kingdom if you need assistance...\***

Call the Fisher & Paykel Customer Care Centre and talk to one of our Customer Care Consultants.

**Phone:** 08000 886 605

**Fax:** 08000 886 606

**Website:** [www.fisherpaykel.com](http://www.fisherpaykel.com)

**Postal address:** Fisher & Paykel Appliances Ltd, Maidstone Road, Kingston, Milton Keynes, Buckinghamshire, MK10 0BD

### **In Ireland if you need assistance...\***

**Phone:** 1800 625 174 or 01-8077960

**Fax:** 1800 635 012

**Website:** [www.fisherpaykel.com](http://www.fisherpaykel.com)

**Postal address:** Fisher & Paykel Appliances, Unit D2, North Dublin Corporate Park, Swords, Co. Dublin

\*If you call, write or contact our website please provide: your name and address, model number, serial number, date of purchase and a complete description of the problem. This information is needed in order to better respond to your request for assistance.

**Product details can be found on the inside of the chassis.**

**The filters need to be removed to be able to see them.**

### **Registration**

Register your product with us so we can provide you with the best service possible.

To register your product visit our website: [www.fisherpaykel.com](http://www.fisherpaykel.com)



## CUSTOMER CARE

---

Complete and keep for safe reference:

Model \_\_\_\_\_

Serial No. \_\_\_\_\_

Purchase Date \_\_\_\_\_

Purchaser \_\_\_\_\_

Dealer \_\_\_\_\_

Suburb \_\_\_\_\_

Town \_\_\_\_\_

Country \_\_\_\_\_

## EUROPEAN DIRECTIVE 2012/19/EU ON WASTE ELECTRICAL AND ELECTRONIC EQUIPMENT (WEEE)

---

**EU** This appliance is marked according to the European Directive 2012/19/EU on Waste Electrical and Electronic Equipment (WEEE). By ensuring this product is disposed of correctly, you will help prevent potential negative consequences for the environment and human health, which could otherwise be caused by inappropriate handling of this product.

The symbol  marked on the serial plate, or on the documents accompanying the product, indicates that this appliance cannot be treated as household waste. It shall be handed over to the applicable collection point for the recycling of electrical and electronic equipment. Disposal of the appliance shall be carried out in accordance with the local environment regulations for waste disposal.

For more detailed information about treatment, recovery and recycling of this product, please contact your local city office, your household waste disposal service or your Fisher & Paykel retailer/dealer from whom you purchased this product.

**FISHERPAYKEL.COM**

© Fisher & Paykel Appliances 2023. All rights reserved.

The models shown in this guide may not be available in all markets  
and are subject to change at any time.

The product specifications in this guide apply to the specific products and  
models described at the date of issue. Under our policy of continuous product  
improvement, these specifications may change at any time.

For current details about model and specification availability in your country,  
please go to our website or contact your local Fisher & Paykel dealer.

**106076A 07.23**