

**Series 4, Free-standing fridge-freezer with freezer at bottom, 203 x 60 cm, Stainless steel look, Silver KGN392LEBG**



**No Frost bottomfreezer : no need to defrost your freezer**

- **VitaFresh:** keeps food fresh for longer in climate-controlled drawers at around 0°C.
- **Easy Access Shelf:** a pull-out glass shelf for easier access to everything inside your fridge.
- **Perfect Fit:** place your fridge right next to walls or other appliances to save space.
- **LED lighting:** all your items in perfect view.
- **Individual Temperature Control:** separate temperature settings for your fridge and freezer.

---

Energy Efficiency Class: .....	E
Average annual energy consumption in kilowatt hour per year (kWh/a): .....	238 kWh/annum
Sum of volume of frozen compartments: .....	89 l
Sum of volume of chill compartments: .....	279 l
Airborne acoustical noise emissions : .....	39 dB(A) re 1pW
Airborne acoustical noise emission class: .....	C
Built-in / Free-standing: .....	Freestanding
Door panel options: .....	Not possible
Height: .....	2030 mm
Width of the appliance: .....	600 mm
Depth: .....	660 mm
Net weight: .....	70.2 kg
Connection rating: .....	100 W
Fuse protection: .....	10 A
Door hinge: .....	Right reversible
Voltage: .....	220-240 V
Frequency: .....	50 Hz
Length electrical supply cord: .....	240.0 cm
Number of compressors: .....	1
Number of independent cooling systems: .....	2
Interior ventilator: .....	No
Reversible Door Hinge: .....	Yes
Number of Adjustable Shelves in fridge compartment: .....	3
Shelves for Bottles: .....	No
Frost free system: .....	Fridge and freezer
Installation typology: .....	Free-standing

---



## Series 4, Free-standing fridge-freezer with freezer at bottom, 203 x 60 cm, Stainless steel look, Silver KGN392LEBG

### No Frost bottomfreezer : no need to defrost your freezer

- KGN392LEBG
- No Frost, Fridge freezer
- Cambered door, High-door design Stainless steel look

#### Performance and Consumption

- EU19\_EEK\_D: E
- Total Volume : 368 l
- Annual Energy Consumption: 238 kWh/a
- Noise Level : 39 dB , EU19\_Noise emission class\_D: C

#### Functions

- Stainless steel look doors and Pearl grey (VZF 07127) side panels
- Integrated vertical handle
- Bright interior LED fridge light in fridge section

#### Design features

- NO\_FROST\_NEU\_BL, never have to defrost ever again
- Separate, electronic temperature control with LED display
- Two separate cooling circuits allow independent temperature control and prevents the transference of humidity between the fridge and freezer cavity
- Super Cooling: automatic deactivation
- Optical and acoustical
- SuperFreeze function with automatic deactivation
- Freezer malfunction warning signal: optical and acoustical warning system

#### Design features

- Net Fridge Volume : 279 l
- MultiAirflow system - improves circulation of air around the fridge
- 5 safety glass shelves (3 height adjustable)
- Door shelves in fridge door: 1 large and 3 small.

#### Freshness System

- 1 VitaFresh drawer - Fish and meat stay fresh for longer
- 1 VitaFresh drawer with humidity control - Fruits and vegetables retain vitamins and stay fresh for longer

#### Food freshness system

- Net Freezer Volume : 89 l
- Freezing capacity 24h : 10 kg
- Temperature rise time : EU19\_Temperature rise time\_D: 12 H
- EU19\_Fast freezer facility\_D
- 3 freezer drawers

#### Dimension and installation

- Dimensions: 203 cm H x 60 cm W x 66 cm D

#### Key features - Fridge section

- Right hinged door, door reversible
- Height adjustable front feet
- Connection value 100 W

- 220 - 240 V
- Climate Class: SN-T
- Length of power cord:240 cm

#### Key features - Freezer section

- 3 x egg tray, 1 x ice cube tray

#### Country Specific Options

- Based on the results of the standard 24-hour test. Actual consumption depends on usage/position of the appliance.
- To achieve the declared energy consumption, the distanceholders have to be used. As a result, the appliance depth increases by about 3.5 cm. The appliance used without the distance holder is fully functional, but has a slightly higher energy consumption.

#### Design features

#### Dimension and installation

#### Additional features

**Series 4, Free-standing fridge-freezer  
with freezer at bottom, 203 x 60 cm,  
Stainless steel look, Silver  
KGN392LEBG**

Appliance Name	a	b	c	d	e	f	g
KGN39/KGF39 (int. handle)	2030	600	660	590	600	1210	660
KGN39/KGF39 (ext. handle)	2030	600	660	590	640	1210	700

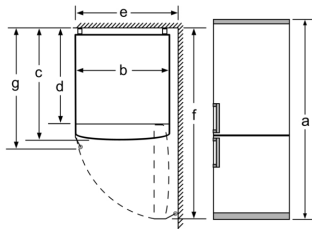

Specification	
a	Height
b	Width
c	Depth with door closed, without handle
d	Cabinet depth
e	Width with door opened to 90°
f	Depth with door opened
g	Depth with door closed, with handle

measurements in mm

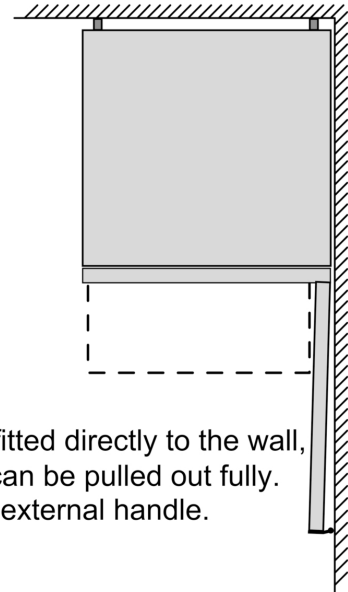

If the appliance is fitted directly to the wall,  
all of the drawers can be pulled out fully.  
\* With and without external handle.