

# AEG

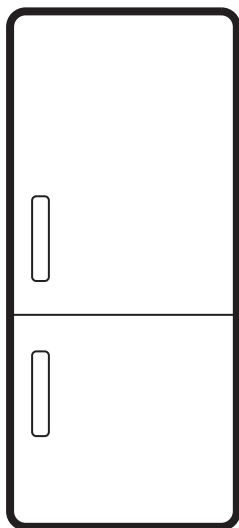

[aeg.com/register](https://aeg.com/register)



EK7C75S  
NSC7G752ES  
NSC7P751CS



responsible for any injuries or damage that result from incorrect installation or usage. Always keep the instructions in a safe and accessible location for future reference.

### **1.1 Children and vulnerable people safety**

- This appliance can be used by children aged from 8 years and above and persons with reduced physical, sensory or mental capabilities or lack of experience and knowledge if they have been given supervision or instruction concerning the use of the appliance in a safe way and understand the hazards involved. Children aged from 3 to 8 years and persons with very extensive and complex disabilities are allowed to load and unload the appliance provided that they have been properly instructed. Children of less than 3 years of age should be kept away from the appliance unless continuously supervised.
- Children should be supervised to ensure that they do not play with the appliance.
- Children shall not carry out cleaning and user maintenance

of the appliance without supervision.

- Keep all packaging away from children and dispose of it appropriately.

### **1.2 General Safety**

- This appliance is for storing food and beverages only.
- This appliance is designed for single household domestic use in an indoor environment.
- This appliance may be used in, offices, hotel guest rooms, bed & breakfast guest rooms, farm guest houses and other similar accommodation where such use does not exceed (average) domestic usage levels.
- To avoid contamination of food respect the following instructions:
  - do not open the door for long periods;
  - clean regularly surfaces that can come in contact with food and accessible drainage systems;
  - store raw meat and fish in suitable containers in the refrigerator, so that it is not in contact with or drip onto other food.

- **WARNING:** Keep ventilation openings, in the appliance enclosure or in the built-in structure, clear of obstruction.
- **WARNING:** Do not use mechanical devices or other means to accelerate the defrosting process, other than those recommended by the manufacturer.
- **WARNING:** Do not damage the refrigerant circuit.
- **WARNING:** Do not use electrical appliances inside the food storage compartments of the appliance, unless they are of the type recommended by the manufacturer.
- Do not use water spray and steam to clean the appliance.
- Clean the appliance with a moist soft cloth. Only use neutral detergents. Do not use abrasive products, abrasive cleaning pads, solvents or metal objects.
- When the appliance is empty for long period, switch it off, defrost, clean, dry and leave the door open to prevent mould from developing within the appliance.
- Do not store explosive substances such as aerosol cans with a flammable propellant in this appliance.
- If the supply cord is damaged, it must be replaced by the manufacturer, its Authorised Service Centre or similarly qualified persons in order to avoid a hazard.

## 2. SAFETY INSTRUCTIONS

### 2.1 Installation

#### **WARNING!**

Only a qualified person must install this appliance.

- Remove all the packaging.
- Do not install or use a damaged appliance.
- Do not use the appliance before installing it in the built-in structure due to safety manner.
- Follow the separate instructions for the appliance installation and door reversing available on our website.
- Always take care when moving the appliance as it is heavy. Always use safety gloves and enclosed footwear.
- Make sure the air can circulate around the appliance.
- At first installation or after reversing the door, wait at least 4 hours before connecting the appliance to the power supply. This is to allow the oil to flow back in the compressor.
- Before carrying out any operations on the appliance (e.g. reversing the door), remove the plug from the power socket.
- Do not install the appliance close to radiators or cookers, ovens, or hobs, unless otherwise specified in the installation instructions.
- Do not expose the appliance to the rain.
- Do not install the appliance where there is direct sunlight.
- Do not install this appliance in areas that are too humid or too cold.

- When you move the appliance, lift it by the front edge to avoid scratching the floor.
- Protect the floor from scratches when reversing the appliance door.
- The appliance contains a bag of desiccant. This is not a toy. This is not food. Please dispose of it immediately.

## 2.2 Electrical connection

### **WARNING!**

Risk of fire and electric shock.

### **WARNING!**

When positioning the appliance, ensure the supply cord is not trapped or damaged.

### **WARNING!**

Do not use multi-plug adapters and extension cables.

### **CAUTION!**

Any electrical work required to install this appliance should be carried out by a qualified electrician.

- Make sure that the parameters on the rating plate are compatible with the electrical ratings of the mains power supply.
- The appliance must be earthed.
- Always use a correctly installed shockproof socket.
- If the domestic power supply socket is not earthed, connect the appliance to a separate earth in compliance with current regulations, consulting a qualified electrician.
- Make sure not to cause damage to the electrical components (e.g. mains plug, mains cable, compressor). Contact the Authorised Service Centre or an electrician to change the electrical components.
- The mains cable must stay below the level of the mains plug.
- Connect the mains plug to the mains socket only at the end of the installation. Make sure that there is access to the mains plug after the installation.
- Do not disconnect the appliance by pulling on the mains cable. Always pull on the mains plug.
- This appliance is fitted with a 13 A mains plug. If it is necessary to change the mains

plug fuse, use only a 13 A ASTA (BS 1362) fuse (UK and Ireland only).

## 2.3 Use

### **WARNING!**

Risk of injury, burns, electric shock or fire.



The appliance contains flammable gas, isobutane (R600a), a natural gas with a high level of environmental compatibility. Be careful not to cause damage to the refrigerant circuit containing isobutane.

- Do not change the specification of the appliance.
- Any use of the built-in product as free-standing is strictly prohibited.
- This appliance is intended to be used at ambient temperature ranging from 10°C to 43°C. The specified temperature range guarantees the correct operations of the appliance.
- Do not put electrical appliances (e.g. ice cream makers) in the appliance unless they are stated applicable by the manufacturer.
- If damage occurs to the refrigerant circuit, make sure that there are no flames and sources of ignition in the room. Ventilate the room.
- Do not let hot items to touch the plastic parts of the appliance.
- Do not put soft drinks in the freezer compartment. This will create pressure on the drink container.
- Do not store flammable gas and liquid in the appliance.
- Do not put flammable products or items that are wet with flammable products in, near or on the appliance.
- Do not touch the compressor or the condenser. They are hot.
- Do not remove or touch items from the freezer compartment if your hands are wet or damp.
- Do not freeze again food that has been thawed.
- Follow the storage instructions on the packaging of frozen food.
- Wrap the food in any food contact material before putting it in the freezer compartment.
- Do not allow food to come in contact with the inner walls of the appliance compartments.

## 2.4 Internal lighting

### **WARNING!**

Risk of electric shock.

- This product contains one or more light sources of energy efficiency class F.
- Concerning the lamp(s) inside this product and spare part lamps sold separately: These lamps are intended to withstand extreme physical conditions in household appliances, such as temperature, vibration, humidity, or are intended to signal information about the operational status of the appliance. They are not intended to be used in other applications and are not suitable for household room illumination.

## 2.5 Care and cleaning

### **WARNING!**

Risk of injury or damage to the appliance.

- Before maintenance, deactivate the appliance and disconnect the mains plug from the mains socket.
- This appliance contains hydrocarbons in the cooling unit. Only a qualified person must do the maintenance and the recharging of the unit.
- Check the product regularly for signs of deterioration that may make it unsuitable for food contact, such as cracks, blisters, delamination, shrinkage, stickiness, corrosion, or other visible changes in texture or appearance. Follow the cleaning and care instructions to prevent deterioration.
- Replace the air filter every 6 months. Contact your local dealer to purchase a replacement.
- Regularly examine the drain of the appliance and if necessary, clean it. If the drain is blocked, defrosted water collects in the bottom of the appliance.

## 2.6 Service

- To repair the appliance contact the Authorised Service Centre. Use only original spare parts.
- Please note that self-repair or non-professional repair can have safety consequences and might void the guarantee.
- The following spare parts are available for at least 7 years after the model has been discontinued: thermostats, temperature sensors, printed circuit boards, light sources, door handles, door hinges, trays and baskets. Door gaskets are available for at least 10 years after the model has been discontinued. The duration may be longer in your country. For further information, please visit our website.
- Please note that some of these spare parts are only available to professional repairers, and that not all spare parts are relevant for all models.

## 2.7 Disposal

### **WARNING!**

Risk of injury or suffocation.

- Disconnect the appliance from the mains supply.
- Cut off the mains cable and discard it.
- Remove the door to prevent children and pets to be closed inside of the appliance.
- The refrigerant circuit and the insulation materials of this appliance are ozone-friendly.
- The insulation foam contains flammable gas. Contact your municipal authority for information on how to discard the appliance correctly.
- Do not cause damage to the part of the cooling unit that is near the heat exchanger.

## 3. CONTROL PANEL

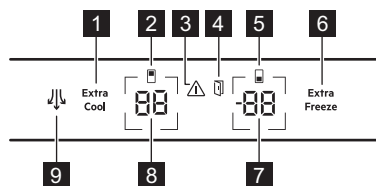

- 1 Extra Cool button / indicator**  
Press to activate/deactivate.
- 2 Fridge compartment indicator**
- 3 Alarm indicator**  
Press any button to deactivate the high temperature alarm.
- 4 Door open alarm indicator**  
Press any button to switch off the sound. The alarm stops after closing the door.
- 5 Freezer compartment indicator**
- 6 Extra Freeze button / indicator**  
Press to activate/deactivate.
- 7 Freezer temperature button / indicator**  
Press to set the freezer temperature (-15°C – -24°C).
- 8 Fridge temperature button / indicator**  
Press to set the fridge temperature (+2°C – +8°C).
- 9 Fan button / indicator**  
Press to activate/deactivate the fan.

### 3.1 Switching on/off

#### The appliance

**Switching on:** Connect the mains plug to the power socket.

**Switching off:** Press and hold the fridge and freezer temperature buttons for 5 sec. Disconnect the mains plug from the power socket.

#### Fridge compartment

**Switching on/off:** Press and hold the fridge temperature button for 5 sec. OF / On appears on the display.

#### Freezer compartment

**i** For selected models only.

**Switching on/off:** Press and hold the freezer temperature button for 5 sec. OF / On appears on the display.

### 3.2 Alarms

**i** Alarm types vary by model.

Press any button to deactivate the sound. The sound switches off automatically after 1 h.

#### High temperature alarm

It activates when temperature in the freezer increases. The freezer temperature indicator shows blinking H°, alarm indicator flashes and the sound is on.

#### Door open alarm

It activates when the fridge/freezer door is left open for 5 min/80 sec. Alarm indicator flashes and sound is on. Close the door to stop the alarm.

### 3.3 MultiSwitch

**i** Available on selected models only.

This function allows you to convert the freezer compartment into a fridge.

**i** Before activating or deactivating the MultiSwitch function remove food from the freezer compartment.

**i** The MultiSwitch compartment is ready to use after 24 h, when it reaches the set temperature.

To convert the compartment:

1. Tap the freezer temperature button repeatedly until the display shows blinking - -.
2. Press - - within the next 7 sec.
3. The freezer temperature indicator shows the temperature of the MultiSwitch compartment (4°C).

**i** When the MultiSwitch function is on, the High temperature alarm and Extra Freeze function are disabled.

❗ The MultiSwitch function deactivates when you switch off the appliance or converted compartment.

❗ The MultiSwitch function resumes operation once the power is restored after a power failure.

To convert the MultiSwitch compartment back:

1. Press the freezer temperature button until -- starts blinking.
2. Press -- within the next 7 sec.

❗ The High temperature alarm starts working again 1 h after deactivating the Multi-Switch function.

### 3.4 Extra Cool and Extra Freeze

#### Extra Cool

Use Extra Cool to rapidly cool warm food in the fridge compartment.

The fan can activate when the function is on. Switch off the function to set a different fridge temperature. The function stops after approx. 6 h.

#### Extra Freeze

Use Extra Freeze to fast freeze in the freezer compartment.

Activate the function at least 24 h before placing the food. The function stops after a max. of 52 h.

### 3.5 Setting mode

It enables you to change the settings: the Sabbath mode, Demo mode, temperature

units. You can also reset the appliance to factory settings:

#### Activating the Setting mode

1. Press and hold the Extra Cool button for approx. 3 sec to activate/deactivate the Setting mode. The display shows blinking SE tt.
2. Once the Setting mode is active, the display shows tS on.

The Setting mode deactivates if you do not interact with the control panel for 60 sec.

#### Navigating the Setting mode

Tap the Extra Cool to change the **setting parameter**. Tap the fridge temperature button to change the setting parameter **value**.

Setting name	Display	Values
Button sounds	tS	On/OFF
Temperature units	CF	°C/°F
Sabbath mode <sup>1) 2)</sup>	Sb	On/OFF
Demo mode	dE	On/OFF
Factory settings	FS	on>03

<sup>1)</sup> Available on selected models only.

<sup>2)</sup> Disables all buttons except for the combination required to deactivate the mode. Alarms are muted except for High temperature alarm.

❗ You can not store food when Demo Mode is on.

## 4. DAILY USE

❗ The equipment varies by model.

### 4.1 Positioning the shelves



**Flexible shelf:** the front half of the shelf can be placed under the second half. Take out the front half carefully and slide it into the lower rail.

### 4.2 Removing the drawers

Always empty the drawers before the removal.

#### GreenZone

Green Zone drawer is placed in the bottom part of the fridge compartment.

1. Pull out the drawer from the fridge extending the rails fully.
2. Push the rails cap and lift up the front of the drawer.

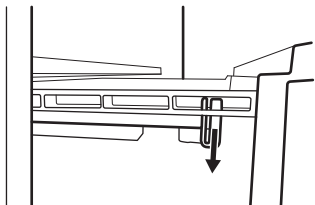

3. Pull the drawer out while lifting it up and detach it from the rails.

To reassemble:

1. Pull out the rails completely.
2. Place the rear part of the drawer on the rails.

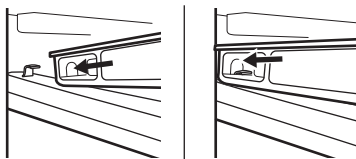

3. Keep the front of the drawer lifted up while pushing the drawer in.

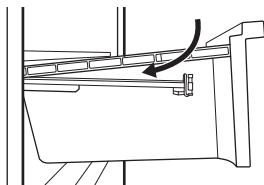

4. Press the front part of the drawer downwards.

### ExtraZone

ExtraZone is a drawer above the GreenZone drawer.

1. Pull out the drawer from the fridge extending the rails fully.
2. Push the rails cap and lift up the front of the drawer.
3. Pull the drawer out while lifting it up and detach it from the rails.

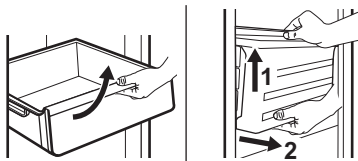

4. Push the rails inside the cabinet.

To reassemble:

1. Place the rear part of the drawer on the fully pull-out rails.
2. Keep the front of the drawer lifted up while pushing the drawer in.

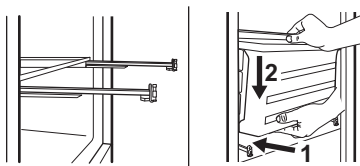

3. Press the front part of the drawer downwards.

### To remove the glass shelf:

1. Unlock lateral gripping from both sides.

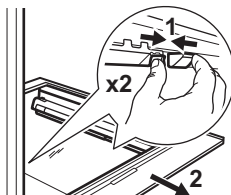

2. Pull the glass shelf support towards yourself.

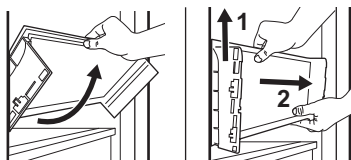

### 4.3 Humidity control

The glass shelf of the GreenZone drawer is fitted with a device that manages the humidity inside the drawer.

**i** Do not place any food products on the humidity control device.

### Manual humidity control

- Slots closed: low quantities of fruit and vegetables.
- Slots opened: larger quantities of fruit and vegetables.

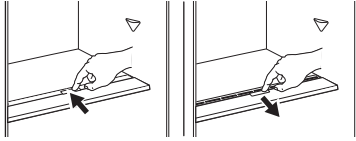

To remove the humidity control device, open the drawer below the glass shelf and pull out the cover.

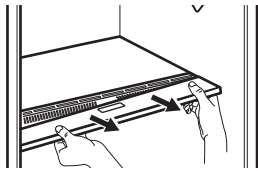

### Automatic humidity control

To remove the humidity control device:

1. Open the drawer below the glass shelf and pull out the cover.

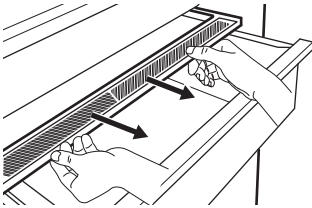

2. To replace the device's white membrane, grab the device in the middle and separate the membrane from the cover by pulling the cover.

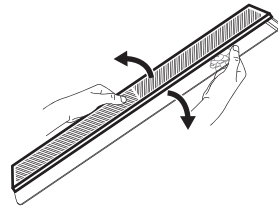

3. Assemble a new membrane into the cover by pressing the edge of the membrane into the cover.

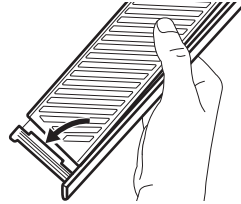

4. Reassemble the humidity control back on the drawer.

**i** Condensation may occur in the Green-Zone drawer. Remove it using a soft cloth.

### 4.4 Fan



Fan activates automatically when needed.  
Do not remove the cover of the fan.

### 4.5 CleanAir+ filter

CleanAir+ purifies the air from odours in the fridge.

On delivery, the filter and its plastic housing are inside a plastic bag. For more details, refer to the "Installing and replacing the CleanAir+ filter".

### 4.6 Bottle storage accessories

**i** Store only closed bottles or cans, placing them with the opening facing front.

Bottle Stop accessory prevents bottles or cans from rolling. Store the bottles or cans on top of each other.

Place the accessory with the silicone base facing down to store the bottles.

**i** Store a max. of 10 kg of bottles and/or cans of different sizes in up to two rows, as shown in the picture.

ⓘ Do not put unpacked food in direct contact with the accessory.

Bottle rack is a shelf dedicated to bottle storage.

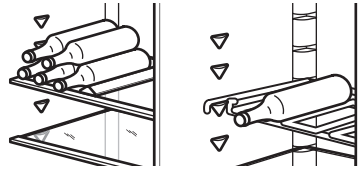

## 5. HINTS AND TIPS

### 5.1 Hints for energy saving

- Freezer: The original configuration ensures the most efficient use of energy.
- Fridge: The configuration with the drawers in the bottom part of the appliance and shelves evenly distributed ensures the most efficient use of energy. Position of the door bins does not affect energy consumption.
- Do not open the door frequently or leave it open longer than necessary.
- Freezer: The colder the temperature setting, the higher the energy consumption.
- Fridge: Do not set too high temperature unless it is required by the characteristics of the food.
- If the ambient temperature is high and the temperature control is set to low temperature and the appliance is fully loaded, the compressor may run continuously, causing frost or ice formation on the evaporator. In this case, set the temperature control toward higher temperature to allow automatic defrosting.
- Do not cover the ventilation grilles or holes.
- Ensure that food products inside the appliance allow air circulation through holes in the rear interior of the appliance.

### 5.2 Hints for freezing

- Do not freeze bottles or cans with liquids, in particular drinks containing carbon dioxide as they may explode during freezing.
- Do not put hot food in the freezer compartment.
- Do not place fresh unfrozen food directly next to already frozen food.
- Do not eat ice cubes, water ices or ice lollies immediately after taking them out of the freezer to avoid frostbites.
- Do not re-freeze defrosted food.

### 5.3 Hints for storage of frozen food

- Freezer compartment is marked with .
- Good temperature setting that ensures preservation of frozen food products is a temperature less than or equal to  $-18^{\circ}\text{C}$ .
- Higher temperature setting inside the appliance may lead to shorter shelf life.
- The whole freezer compartment is suitable for storage of frozen food products.
- Leave enough space around the food to allow air to circulate freely.

### 5.4 Shelf life for freezer compartment

Type of food	Shelf life (months)
Bread	3
Fruits (except citrus)	6 - 12
Vegetables	8 - 10
Leftovers without meat	1 - 2
<b>Dairy food:</b>	
Butter	6 - 9
Soft cheese (e.g. mozzarella)	3 - 4
Hard cheese (e.g. parmesan, cheddar)	6
<b>Seafood:</b>	
Fatty fish (e.g. salmon, mackerel)	2 - 3
Lean fish (e.g. cod, flounder)	4 - 6
Shrimps	12
Shucked clams and mussels	3 - 4
Cooked fish	1 - 2
<b>Meat:</b>	
Poultry	9 - 12

Type of food	Shelf life (months)
Beef	6 - 12
Pork	4 - 6
Lamb	6 - 9
Sausage	1 - 2
Ham	1 - 2
Leftovers with meat	2 - 3

## 5.5 Hints for food refrigeration

**i** Fresh food compartment is the space above the GreenZone drawer.

- Good temperature setting that ensures preservation of fresh food is a temperature less than or equal to +4°C.

- Always use closed containers for liquids and for food, to avoid flavours or odours in the compartment.
- To avoid the cross-contamination between cooked and raw food, cover the cooked food and separate it from the raw one.
- Wrap and place meat on the glass shelf above the vegetable drawer.
- Defrost the food inside the fridge.
- Do not insert hot food inside the appliance.
- Clean fruit and vegetables and place in a dedicated drawer (vegetable drawer).
- Do not keep exotic fruits in the fridge.
- Do not keep vegetables like tomatoes, potatoes, onions, and garlic in the fridge.
- Close the bottles before you put them into the fridge.
- Turn on the fan to accelerate cooling down of the food.

## 6. CARE AND CLEANING

### 6.1 Cleaning the interior

Before first use clean the interior and accessories with lukewarm water and neutral soap, then dry. Clean the equipment and door gaskets regularly.

Clean the control panel with a damp cloth and dry it with a soft cloth. Do not use any detergents.

Clean the defrost water drain hole, located at the back of the fridge compartment, using the tube cleaner regularly.

**i** Do not wash the accessories and appliance parts in a dishwasher.

### 6.2 Defrosting the appliance

#### Fridge:

Defrosting of the fridge compartment is automatic.

#### Freezer:

The freezer compartment is frost free.

### 6.3 Installing and replacing the CleanAir+ filter

**i** Handle the air filter carefully to avoid scratching its surface.

Install the air filter before activating the appliance.

1. Open the plastic housing and put the pleated surface on the grid, fitting the filter inside the marked area on the gridded surface.

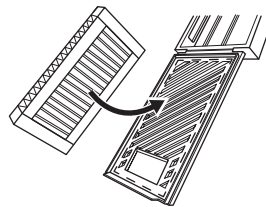

2. Hold the filter down while closing the plastic housing until you hear a click.

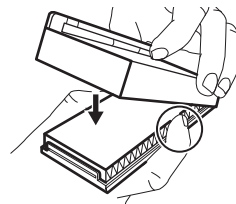

3. Remove the top glass shelf from the fridge compartment. Slip the plastic housing with the air filter on the left side of the glass shelf.

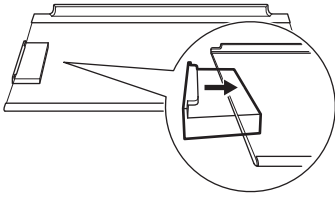

4. Insert the glass shelf back in the fridge compartment. Do not hit the filter.

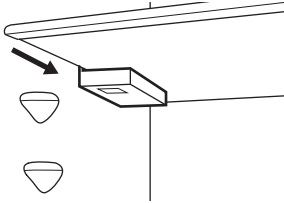

### Replacing the air filter

1. Open the filter housing.

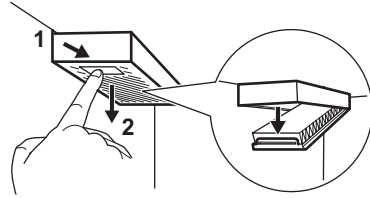

2. Remove the used air filter.
3. Insert the new air filter in the housing and close it.

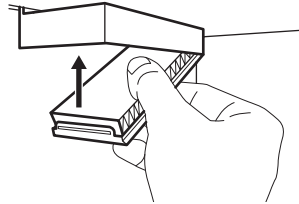

## 7. TROUBLESHOOTING

### The appliance does not operate.

- Connect the mains plug to the mains socket correctly.
- Switch on the appliance.
- Ensure there is voltage in the mains socket. Contact a qualified electrician.

### The appliance is noisy.

Check if the appliance is supported properly.

### Acoustic or visual alarm is on.

Close the door or press any button to deactivate acoustic alarm.

### The compressor operates continually.

- Adjust the temperature.
- Wait for the temperature to stabilize.
- Allow food to cool to room temperature before storing.
- Close the door correctly.

### Door is misaligned or interferes with ventilation grill.

Refer to installation instructions.

### Door does not open easily.

Wait a few seconds between closing and re-opening of the door.

### There is too much frost and ice.

- Close the door correctly.
- Clean or replace the gasket.
- Wrap the food properly.
- Adjust the temperature.

### Water flows on the rear plate of the refrigerator.

This is a part of defrosting process.

### There is too much condensed water inside the fridge.

- Open the door only when necessary and close it completely.
- Set the warmer temperature in the refrigerator (approx. 6-7°C) in summer and autumn.

### Water flows inside the fridge.

- Ensure that food does not touch the rear plate.
- Clean the water outlet.

### Water flows on the floor.

Attach the melting water outlet to the evaporative tray.

### Temperature cannot be set.

Switch off Extra Freeze function or Extra Cool function.

### dE on appears on the display.

- Refer to the "Demo mode" in "Setting mode" section.

### Er CE, the alarm indicator is on.

Contact the Authorised Service Centre. The cooling system keeps food cold. Temperature adjustment is disabled.

### Er t1 or Er t3 or Er t5 alternately with the current setting, the alarm indicator is on.

Contact the Authorised Service Centre. The cooling system keeps food cold. Temperature adjustment is disabled.

### The lamp does not work or the door gaskets are damaged.

Contact the Authorised Service Centre.

## 8. TECHNICAL DATA

The technical information is on the energy label and on the appliance rating plate, which may be located on or inside the appliance.

### For Switzerland only

Voltage: 220-240 V

Frequency: 50 Hz

### For EU only

The QR code on the energy label supplied with the appliance provides a web link to the information related to the performance of the appliance in the EU EPREL database. Keep the energy label for reference together with the user manual and all other documents pro-

vided with this appliance. It is also possible to find the same information in EPREL using the link <https://eprel.ec.europa.eu> and the model name and product number that you find on the rating plate of the appliance. See the link [www.theenergylabel.eu](http://www.theenergylabel.eu) for detailed information about the energy label.

### For UK only

The QR code on the energy label supplied with the appliance provides a web link to the information related to the performance of the appliance. Keep the energy label for reference together with the user manual and all other documents provided with this appliance.

## 9. INFORMATION FOR TEST INSTITUTES

Installation and preparation of the appliance for any EcoDesign verification shall be compliant with:

UK	BS EN 62552
EU, Switzerland, Israel	EN 62552
Australia	IEC 62552
South Africa	SANS 62552

UAE	UAE.S 5010-3:2022
GCC	SASO-2892_2018

Ventilation requirements, recess dimensions and minimum rear clearances shall be as stated in this User Manual in "Installation". Contact the manufacturer for any other further information, including loading plans.

## 10. ENVIRONMENTAL CONCERNS

Recycle materials with the symbol . Put the packaging in relevant containers to recycle it. Help protect the environment and human health by recycling waste of electrical and electronic appliances. Do not dispose of ap-

pliances marked with the symbol  with the household waste. Return the product to your local recycling facility or contact your municipal office.

A series of 20 horizontal dotted lines for writing.

